

本使用手册为亨斯迈(杭州)电力技术有限公司编制, 版权所有, 不得翻制。
产品手册因软件或技术改进而做相应升级, 恕不另行通知。

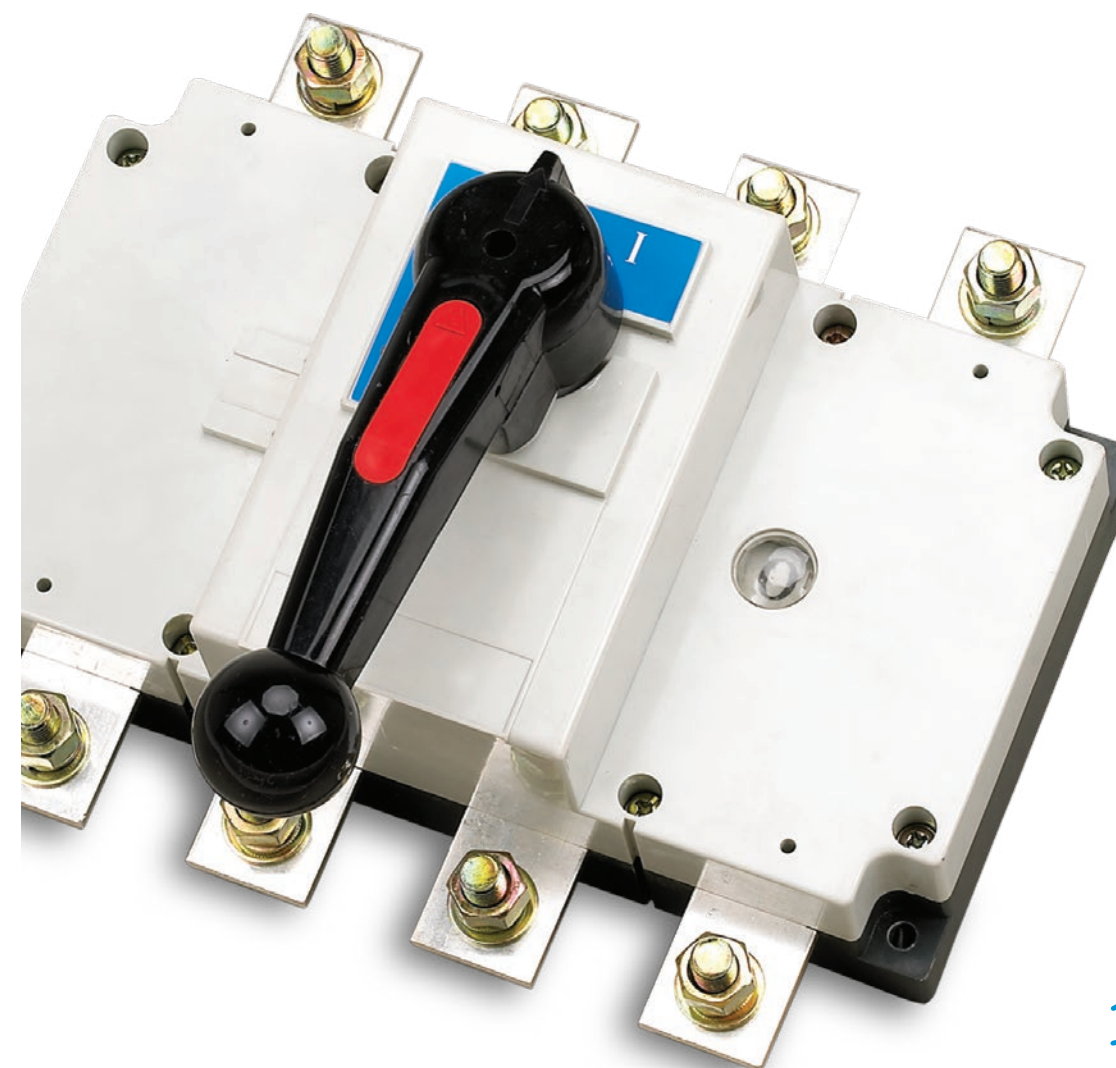

EXD
负荷隔离开关



亨斯迈(杭州)电力技术有限公司
Hertzman(Hangzhou)Power Technology Co.,Ltd.

地址: 杭州市滨江区江陵路88号
电话: 0571-8791 1396
传真: 0571-8826 1796
邮编: 310051
官网: www.hertzmanpower.com

THE POWER OF ENGINEERING  POWER

EXD
负荷隔离开关

EXD-40~63A

◆正面直接操作 Front direct operation

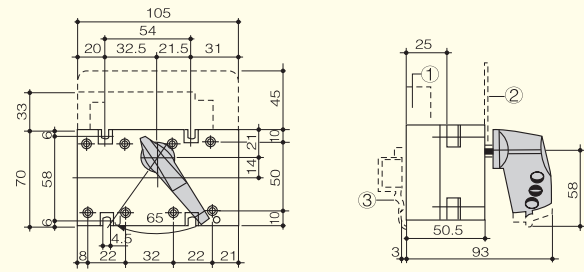

- 1.常开/常闭预断开辅助触点 1. NO/NC pre-breaking auxiliary contact
- 2.端子护屏 2. Terminal barrier
- 3.DIN轨道固定用的夹子 3. Clamp for fixing DIN rail

◆正面柜外操作 Front operation outside the cabinet

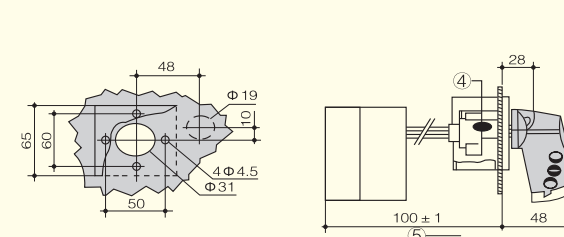

- 4.手柄锁具滑动锁舌宽30mm
- 5.带加长连轴的最小长度: 125 ± 1
- 4.The width of sliding dead bolt of handle lock is 30mm.
- 5.The min length of extension shaft is 125 ± 1

EXD-80~100A

◆正面直接操作 Front direct operation

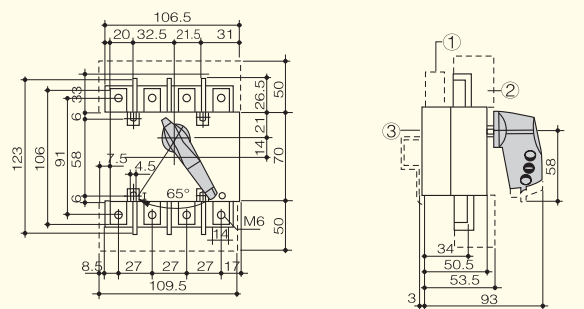

- 1.预断开辅助触点 1.Pre-breaking auxiliary contact
- 2.端子护屏 2.Terminal barrier
- 3.DIN轨道固定用的夹子 3.Clamp for fixing DIN rail

◆正面柜外操作 Front operation outside the cabinet

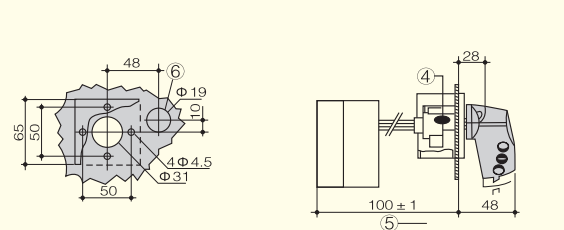

- 4.手柄锁具滑动锁舌宽30mm
- 5.带加长连轴的最小长度: 125 ± 1
- 6.手柄锁具开孔
- 4.The width of sliding dead bolt of handle lock is 30mm.
- 5.The min length of extension shaft is 125 ± 1
- 6.Hole of handle lock



EXD
负荷隔离开关

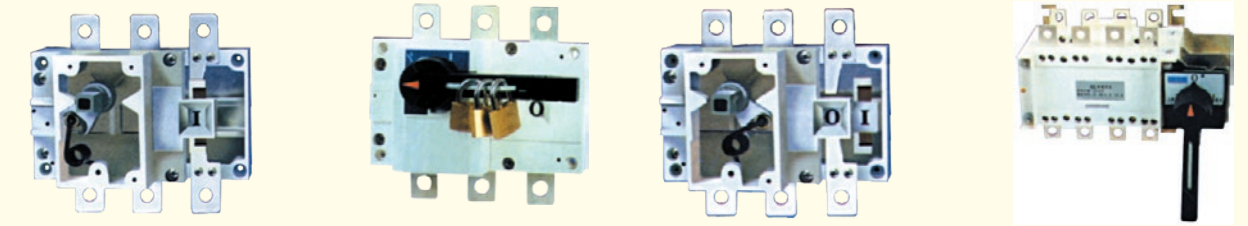

使用环境 Service environment

- 1. EXD 隔离开关在下列条件下能可靠工作
- 2. 海拔高度不超过2000米;
- 3. 环境温度不高于40℃, 不低于-5℃;
- 4. 相对湿度不大于95%;
- 5. 无爆炸危险介质环境;
- 6. 无雨雪侵袭环境;

- 1. EXD switch can operate under the following conditions
- 2. Altitude not more than 2000m;
- 3. The range of ambient temperature is from 5℃ to 40℃;
- 4. Relative humidity not more than 95%;
- 5. The environment without any explosive medium.
- 6. The environment without any rain or snow attacking.

注: 若预期使用于周围空气温度高于+40℃或低于-5℃~-45℃的条件下, 用户应向制造厂说明

Note: If the product is expected to be used in the environment where temperature is over +40℃ or below -5℃ ~ -45℃, users shall tell it to the manufacturer.

用途 Application

- ◆交流50赫兹, 额定电压至660V, 直流额定电压至440V, 额定电流至1600A。用于不频繁接通与分断电路。
- ◆AC 50Hz, rated voltage 660V, DC rated voltage 440V, rated current 1600A. It is used for making and breaking circuit infrequently.

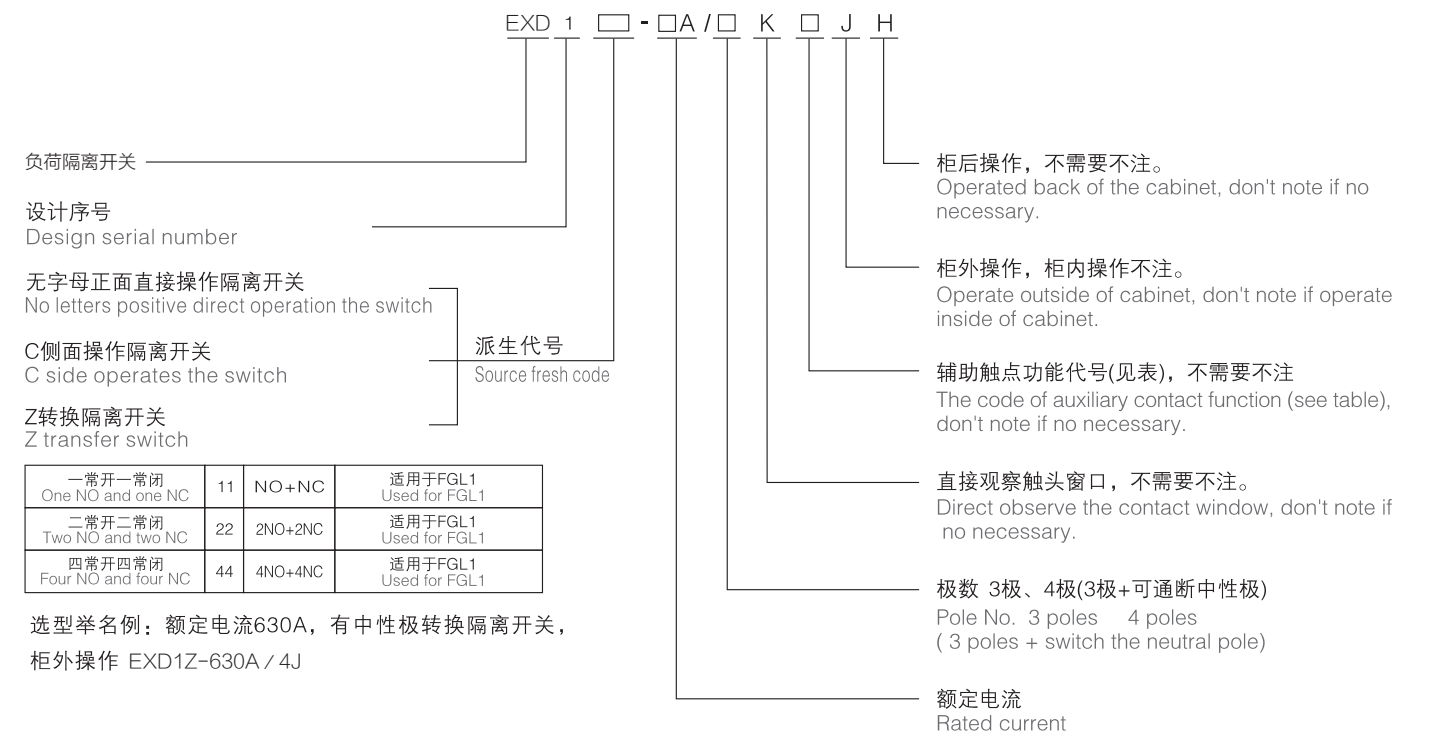

EXD
负荷隔离开关

EXD负荷-隔离开关 从125-630A是模块化设计基础型, 具有三极, 四极(三极+可通断中性极), 适用于电路和接通与分断或电气隔离。

正面设有标记窗口指示触头通断状态。

根据需要可提供后面观察窗口, 直接观察触头通断状态, 窗口样式见EXD1-125~630A/H 柜后操作隔离开关。

操作方式 Operation mode

1. 直接操作: 手柄直接安装在开关中间。
2. 柜外操作: 手柄安装在配电柜柜门外。
3. 可配装两组辅助触点。

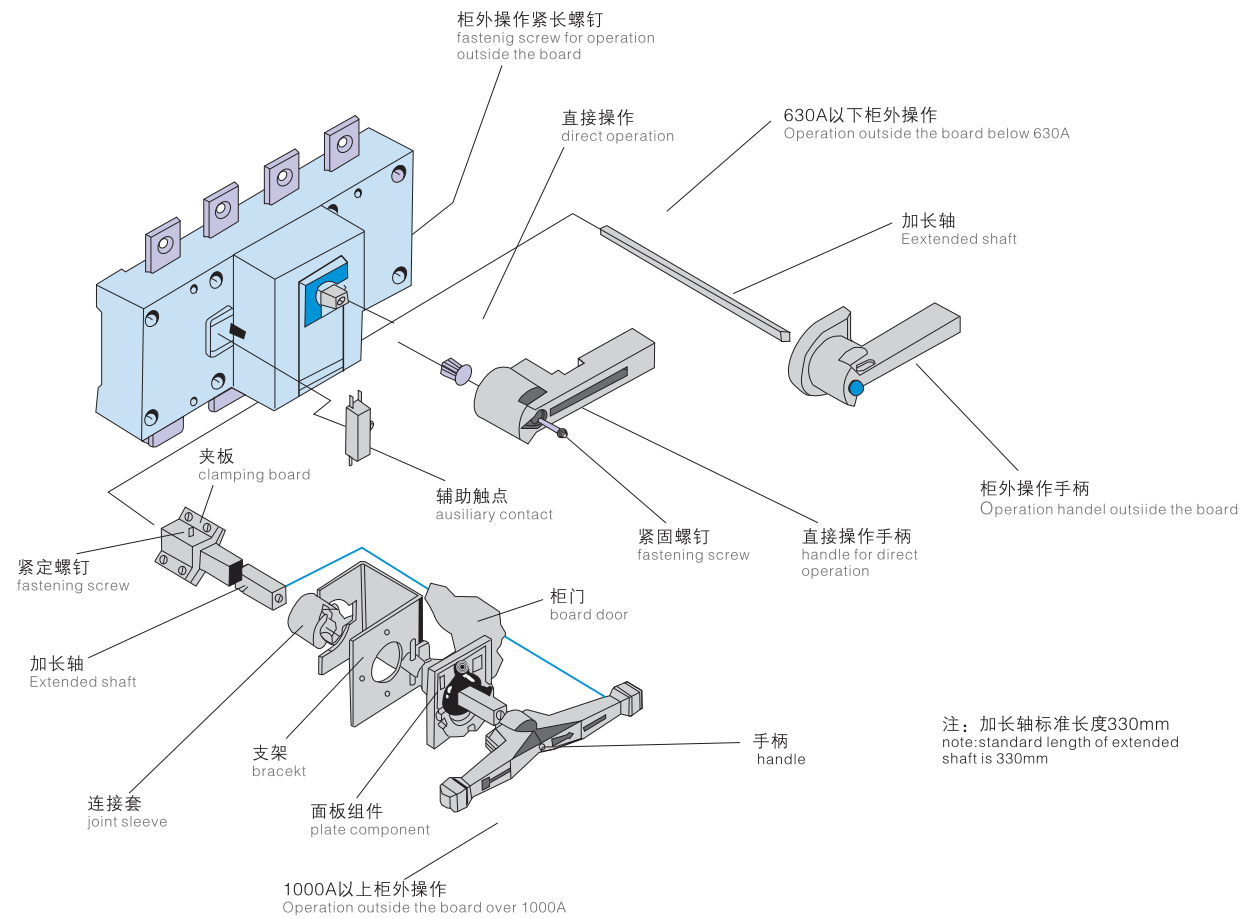

EXD
负荷隔离开关

约定发热电流I _{th} A Conventional heating current	125A	160A	200A	250A	315A	400A	500A	630A
约定发热电压U _i (V) Rated insulation voltage U _i (V)	750	750	750	750	1000	1000	1000	1000
介电强度 V Dielectric strength	5000	5000	5000	5000	8000	8000	8000	8000
额定冲击耐受电压 U _{imp} KV(安装类别IV) Rated impaction withstand voltage U _{imp} KV (Installation sort IV)	8	8	8	8	12	12	12	12
额定工作电流 I _e (A) Rated working current I _e (A)								
380V AC21 AC22 AC23	125	160	200	250	315	400	500	630
	125	160	200	250	315	400	500	630
	125	160	200	250	315	340	425	500
660V AC21 AC22 AC23	125	160	160	200	315	400	400	500
	125	160	160	160	315	315	315	315
	80	80	100	125	125	125	125	125
220V AC21 AC22 AC23	125	160	200	250	315	400	500	630
	125	160	200	250	315	400	400	500
	125	125	160	200	315	400	400	500
440V AC21 AC22 AC23	100	125	160	200	315	400	400	500
	100	125	160	200	315	400	400	500
	100	125	160	200	315	400	400	500
电动机功率 P(KW) Motor power P(KW)								
380V 660V	63	80	100	132	160	220	280	315
	75	75	90	110	185	185	185	185
过载能力 Overload capacity								
额定短时耐受电流I _{cw} (KA Rms)0.1S/1.0S Rated short-time withstand current I _{cw} (KA Rms)0.1S/1.0S	20/10	20/10	30/12	30/12	45/20	45/20	50/25	50/25
接通分断能力 Making and breaking capacity								
额定接通能力I _{cn} (A Rms)AC23 380V Rated making capacity I _{cn} (A Rms)AC23 380V	1250	1250	2000	2000	3150	4000	4000	4000
额定分断能力I _{cm} (A Rms)AC23 380V Rated breaking capacity I _{cm} (A Rms)AC23 380V	1000	1000	1600	1600	2500	3200	3200	3200
额定短路接通能力I _{cm} (KA峰值) Rated short-circuit making capacity I _{cm} (KA peak value)	12	12	17	17	30	30	40	40
机械寿命(循环操作次数) Mechanical life (rotation operation time)	10000	10000	10000	10000	5500	5500	5500	5500
电气寿命(循环操作次数) Electrical life (rotation operation time)								
额定电压U _e =660V 额定电流I _e Rated voltage U _e =660V Rated current I _e	1500	1500	1500	1500	750	750	750	750
COSΦ=0.95 AC21	1000	1000	1000	1000	500	500	500	500
COSΦ=0.65 AC22	500	500	500	500	250	250	250	250
COSΦ=0.35 AC23								
操作力距(Nm) Operation moment (Nm)	6.5	6.5	10	10	14.5	14.5	14.5	14.5
重量(Kg) Weight (Kg)	3极 3 poles 4极 4 poles	1 1.5	2 2.5	2 2.5	3.5 4	3.5 4	4 4.5	4 4.5